

NM Building design update

Presidential Forum 02/12/18



South Central
COLLEGE

Building steering committee:

- Brad Schloesser – Deans
 - Ryan Langemeier – Faculty
 - Laura Attenberger – Faculty
 - Jay Schmit – Faculty
 - Barb Embacher – Academic Affairs
 - Brian Yingst – Student Affairs
 - Russ Berndt – Facilities
 - Steve Mills – IT
 - Brett Skilbred – NM Foundation
 - Dakota Mathews Schmidt – Student
- 

Basic overview:

- **\$9.6m total**
 - **\$7.1m construction**
 - **Combination of 2014 and 2016 predesigns**
 - **Potentially address 30-50k GSF**
 - **Mix of labs, classrooms, common spaces, infrastructure**
- 

Project Goals

- Increase Student Enrollment & Improve Retention
 - Industry Partners Relations – Support, Research, etc.
 - Improvement Learning Environments – Tech, Equip, etc.
 - Support Student Gathering & Collaboration
 - Less institutional, more friendly
 - Strong Brand & Identity - sense of place & wayfinding
 - Improve Outdoor Campus Connectivity & Use
- 

Three project pillars:

- Allied Health & Nursing
 - Advanced Manufacturing
 - Agribusiness
-
- LAS supports all
- 

The three “do’s” – some examples

Must do:

- Bathrooms – number and accessibility
- Structural issues
- Infrastructure like HVAC and electrical

Should do:

- Improve teaching and learning environment
- Improve space utilization

Could do:

- Provide for things we don’t currently have, like daylighting and greenhouse
- 

Project Schedule

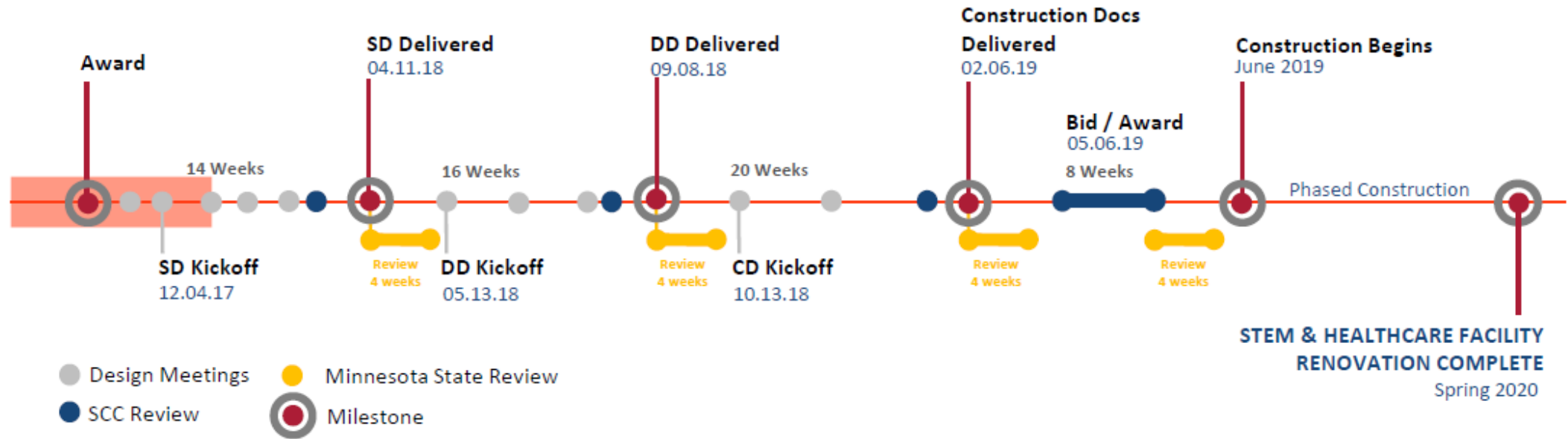

| | Jan | Feb | Mar | Apr | May | Jun | Jul | Aug | Sep | Oct | Nov | Dec |
|------|-----|-----|-------------|-----|---------------|-----|----------------|-------------------|-----|-------------------------------|----------|-----|
| 2017 | | | | | | | Project funded | Arch. RFPs issued | | DLR award Comm. Formed | Begin SD | |
| 2018 | | | | | Begin DD | | | | | Begin CD | | |
| 2019 | | | Const. bids | | Begin constr. | | | | | | | |
| 2020 | | | | | Subst. compl. | | | Fall sem. start | | | | |

CR & LAB "HIVE"

STUDENT LIFE & COMMUNITY "CORE"

INDUSTRIAL "HUB"

EXISTING PROGRAMS

- RESTROOMS
- STAFF
- FITNESS
- SOCIAL / STUDY SPACES
- GENERAL CLASSROOM
- NURSING & ALLIED HEALTH
- AGRIBUSINESS
- LIBERAL ARTS & SCIENCES
- ARTS & COMMUNICATIONS
- BUSINESS
- TRANSPORTATION
- BUILDING DESIGN
- ADVANCED MANUFACTURING

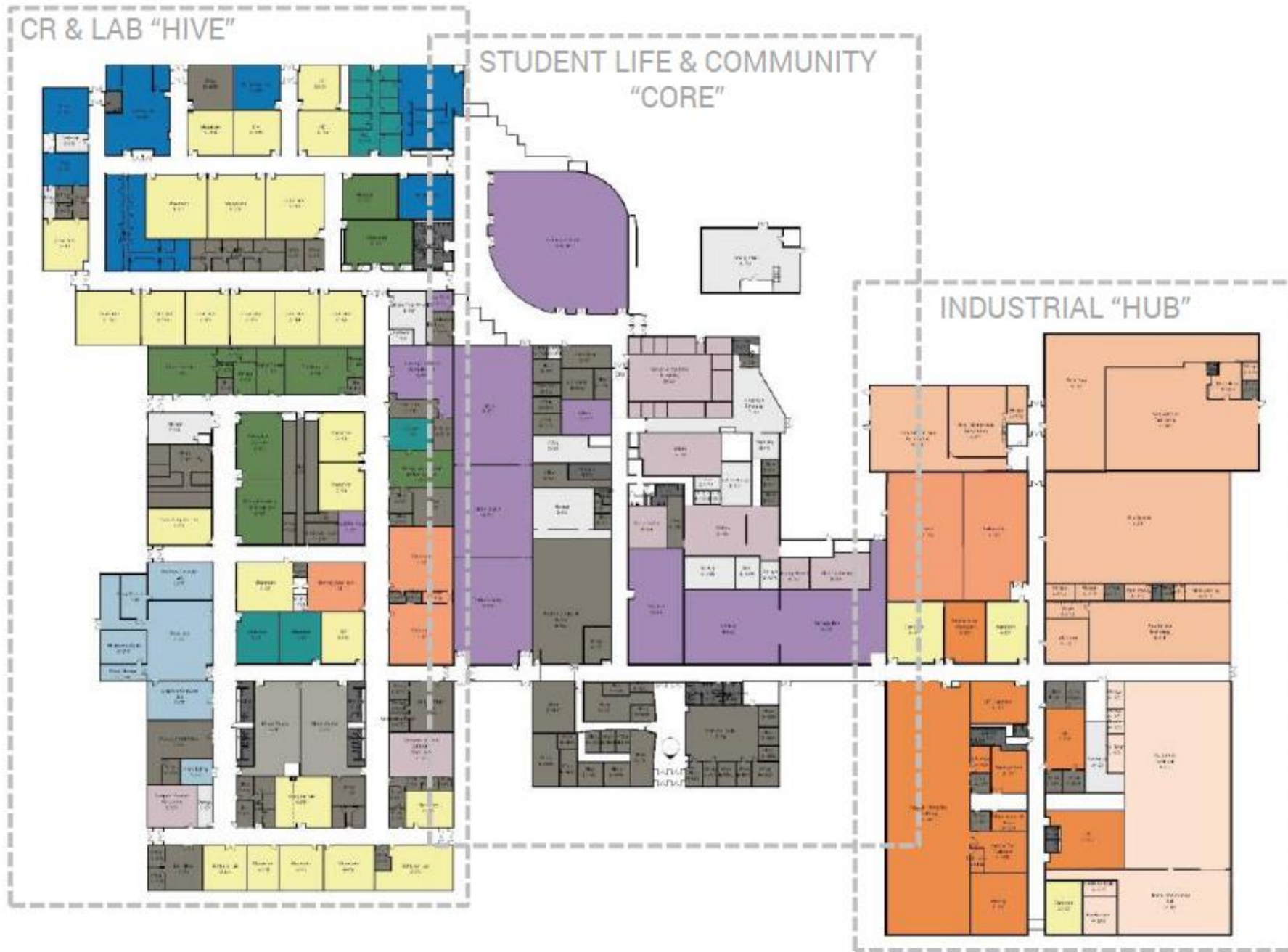

CURRENT UTILIZATION

Goal is 100% (32 hours of use per week)
Classroom Average is 57%
Lab Average is 54%

